

ORDER NO. 20211214-6D

**AN ORDER OF THE COMMISSIONERS COURT OF GUADALUPE COUNTY, TEXAS: (1) ADOPTING THE 2021 REVISED GUADALUPE COUNTY ELECTION PRECINCT PLAN FOR THE RECONFIGURATION OF CERTAIN COUNTY ELECTION PRECINCTS, INCLUDING PUBLIC NOTICE AND ALL RELATED MATTERS, PURSUANT TO CHAPTER 42 OF THE TEXAS ELECTION CODE AND OTHER AUTHORITY; AND (2) PROVIDING FOR AN EFFECTIVE DATE AND COMPLIANCE WITH THE TEXAS OPEN MEETINGS ACT.**

**WHEREAS**, Guadalupe County, Texas (“County”) is a county of the State of Texas, having been duly created and organized under the constitution and laws of Texas, and the Guadalupe County Commissioners Court (“Commissioners Court”) is the governing body of the County; and

**WHEREAS**, Chapter 42 of the Texas Election Code (“Chapter 42”) provides, with certain exceptions, that (1) a county shall in odd-numbered years determine whether its county election precincts comply with certain applicable provisions of state law, (2) the effective date of use for a change to county election precincts shall be the first day of the first even-numbered voting year following the voting year in which the change is ordered, and (3) after adoption of revised county election precincts, notice of those revisions must be given by a county to the public and certain public officials; and

**WHEREAS**, a change in circumstances has occurred which necessitates review and approval by the Commissioners Court of certain revisions to the County’s existing election precinct plan in order to comply with state law, and for the convenience and efficiency of conducting elections, said revisions being hereafter described as the **2021 Revised Guadalupe County Election Precinct Plan** (“2021 Revised Plan”), complete with the maps for said plan attached as **Exhibit A**; and

**WHEREAS**, the Commissioners Court finds that:

- (1) the existing County election precinct plan should be partially revised and reconfigured by the approval of the 2021 Revised Plan described in this order, in compliance with Chapter 42 and other authority, and in the form and scope and in accordance with the plan maps attached as **Exhibit A**;
- (2) the map revisions in **Exhibit A** are in the best interests of the County and the public, and their approval and implementation will increase the convenience and efficiency of conducting elections in the County; and
- (3) all notices required by law shall be performed by the County regarding the approval and implementation of this order, the 2021

Revised Plan, and the **Exhibit A** documents;  
**NOW, THEREFORE, BE IT RESOLVED AND ORDERED BY THE  
COMMISSIONERS COURT OF GUADALUPE COUNTY, TEXAS AS FOLLOWS:**

- (1) Unless otherwise designated in this order, the past, present, or future tense shall each include the other, the masculine, feminine, or neuter gender shall each include the other, and the singular and plural number shall include each other where necessary for a correct meaning.
- (2) All statements made in the caption and preliminary recitals of this order, and all attached documents, are incorporated by reference.
- (3) The Commissioners Court hereby approves this **2021 Revised Guadalupe County Election Precinct Plan** as follows: (a) this 2021 Revised Plan shall begin on January 1, 2022, and on said date, the County's existing election precinct plan shall be hereby revised, replaced, and superseded by the 2021 Revised Plan; and (b) the boundaries of certain election precincts in the existing plan are hereby revised and reconfigured by the approval of this 2021 Revised Plan, in accordance with the documents attached as **Exhibit A**, being the maps for the 2021 Revised Plan.
- (4) This order and all attached documents shall be filed and maintained in the County Clerk's Office.
- (5) The County shall timely: (a) submit copies of this order (including the maps attached as **Exhibit A**) and other documents required by law to the Texas Secretary of State and other public officials for notice and/or approval as required by law; and (b) provide public notice of this order as required by law.
- (6) The 2021 Revised Plan (including the maps attached as **Exhibit A**) shall take effect and become operative on and after January 1, 2022, and thereafter shall be used in all elections for County officers and other elections administered by the County, as required by Chapter 42 and other authority, until such time as a subsequent, revised, and lawfully enacted County election precinct plan or map revision shall be approved.
- (7) The County's staff and attorneys shall assist the Commissioners Court regarding the successful accomplishment of all tasks and preparation of all documents necessary or advisable for the successful implementation of the 2021 Revised Plan.
- (8) Except for certain matters described in paragraphs (3) and (6) of this

order (which matters shall take effect and become operative on and after January 1, 2022), the remainder of this order shall take effect immediately from and after its passage.

- (9) This order was approved and adopted at a meeting of the Commissioners Court held in compliance with Chapter 551 of the Texas Government Code, the Texas Open Meetings Act.

**ORDERED, APPROVED, AND ADOPTED** on the 14 day of December, 2021.

**THE COMMISSIONERS COURT OF  
GUADALUPE COUNTY, TEXAS**

  
\_\_\_\_\_  
Kyle Kutscher  
County Judge

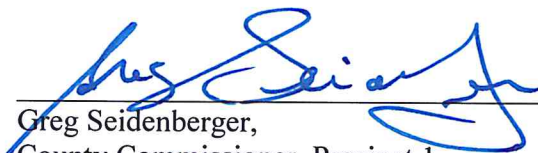
  
\_\_\_\_\_  
Greg Seidenberger,  
County Commissioner, Precinct 1

  
\_\_\_\_\_  
Drew Engelke  
County Commissioner, Precinct 2

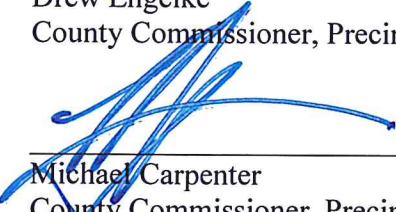
  
\_\_\_\_\_  
Michael Carpenter  
County Commissioner, Precinct 3

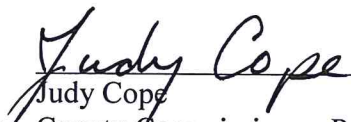
  
\_\_\_\_\_  
Judy Cope  
County Commissioner, Precinct 4

**ATTEST:**

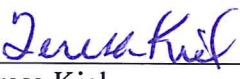
  
\_\_\_\_\_  
Teresa Kiel  
County Clerk





Guadalupe County  
Voting Precincts

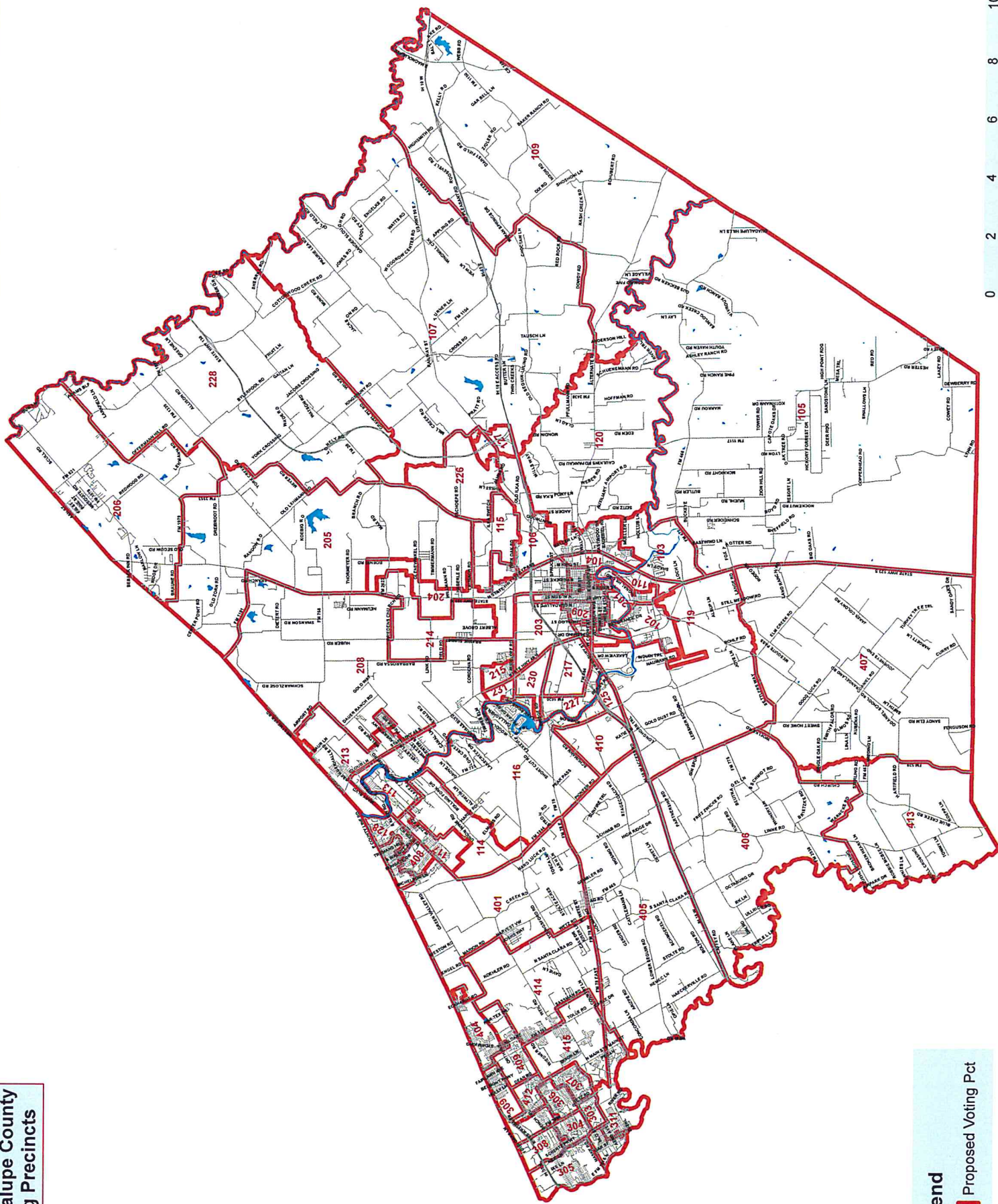

Legend

Proposed Voting Pct

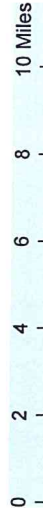



## Proposed Voting Pct 129

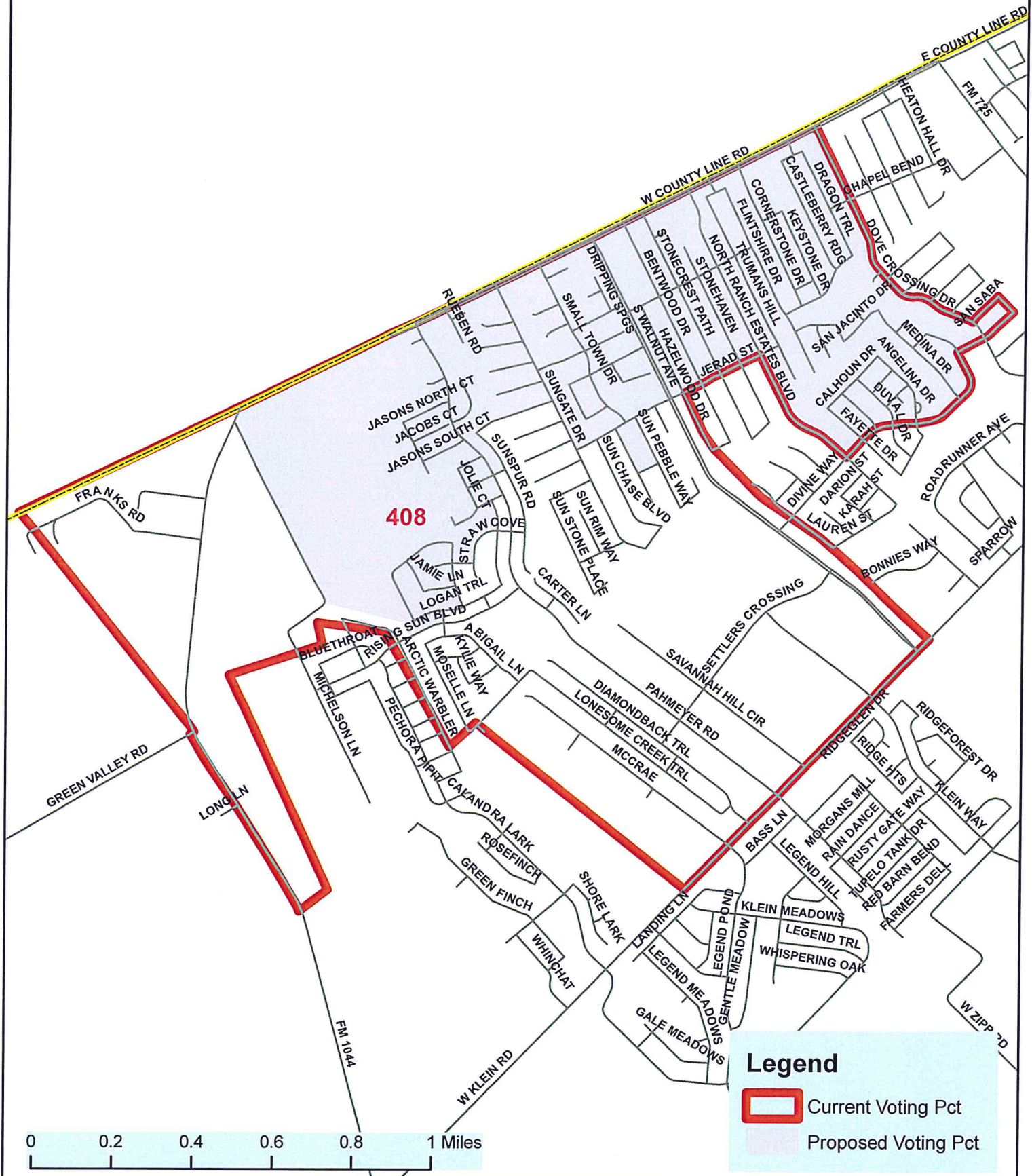



Proposed Voting Pct 212

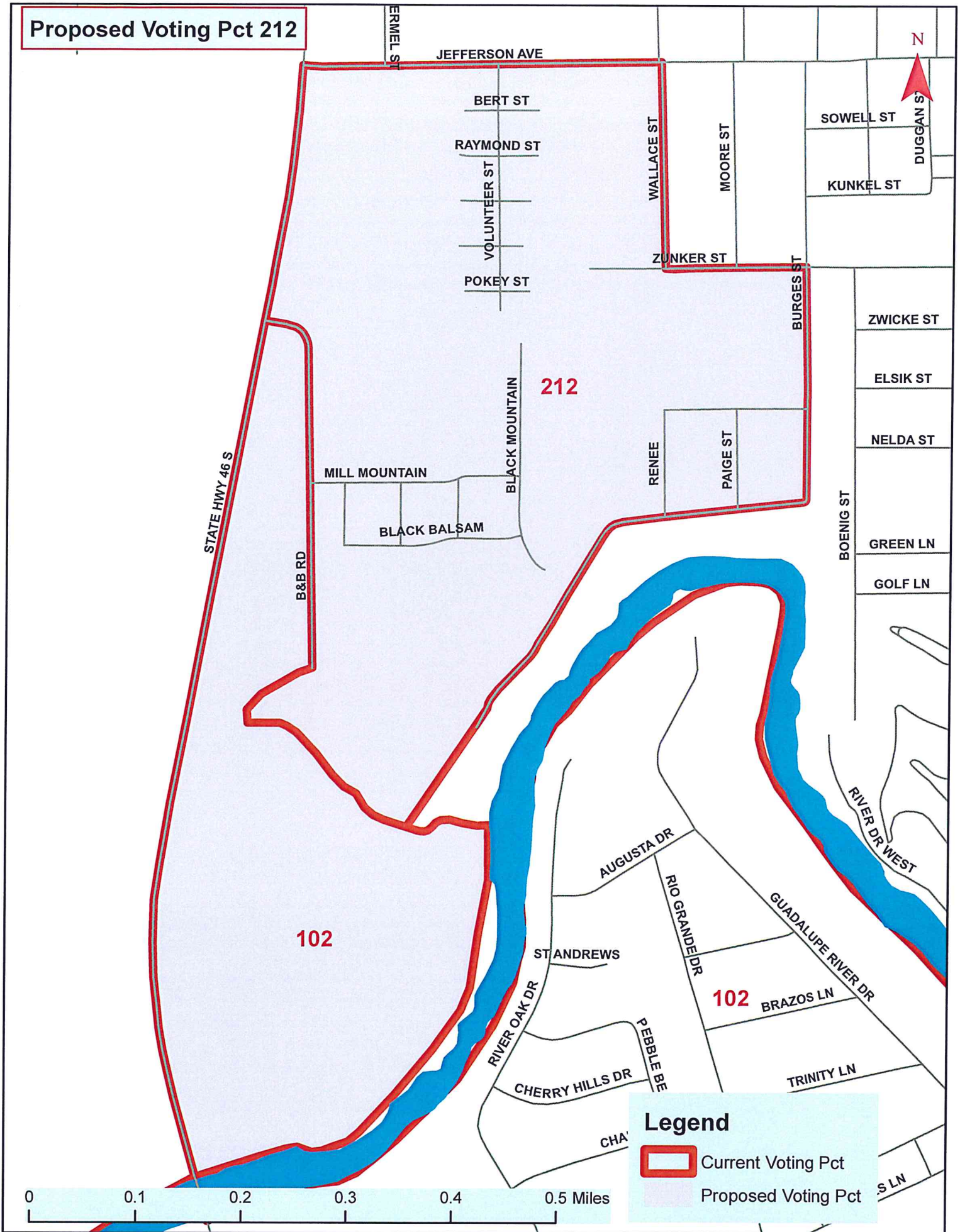



Proposed Voting Pct 227

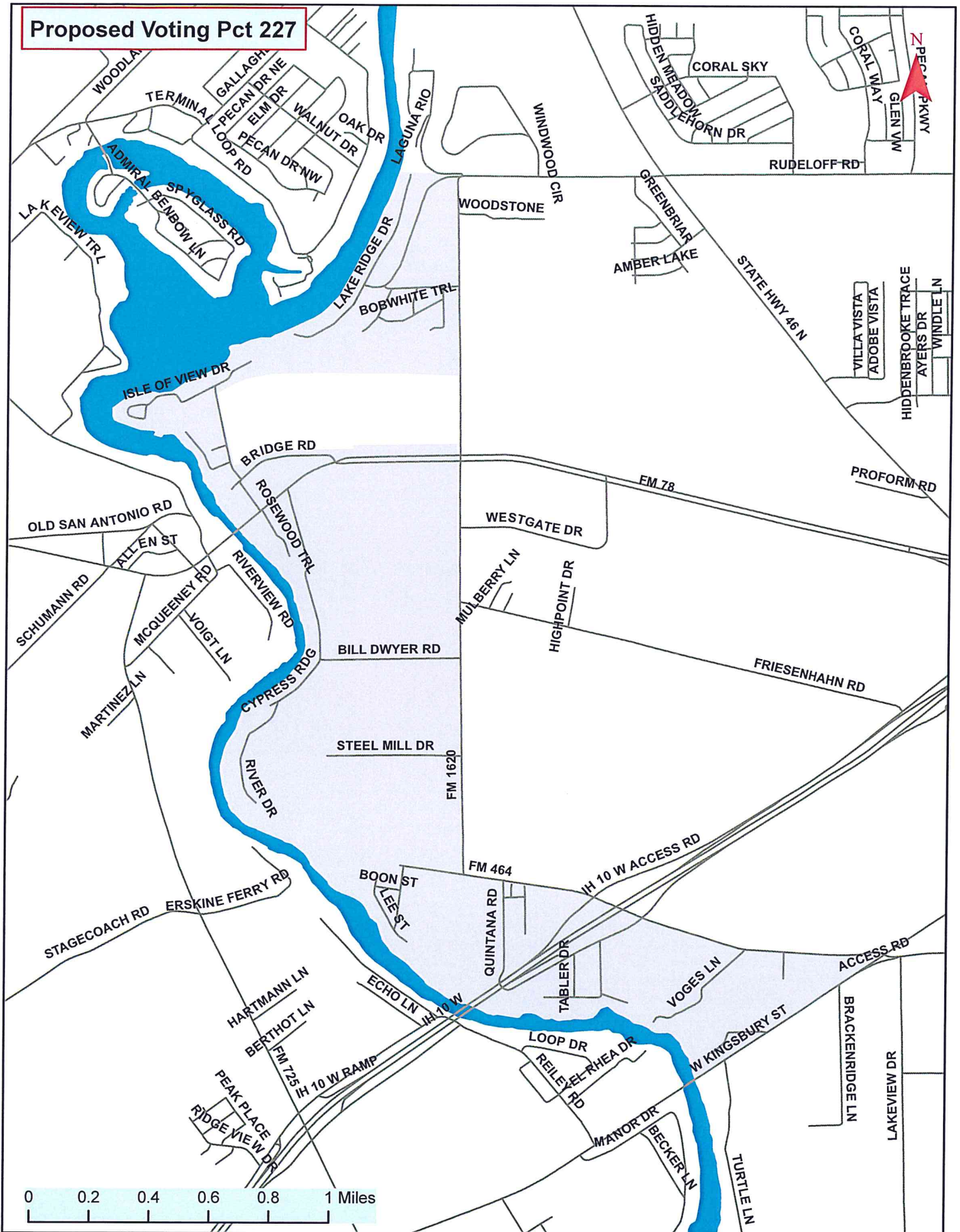



# Proposed Voting Pct 228

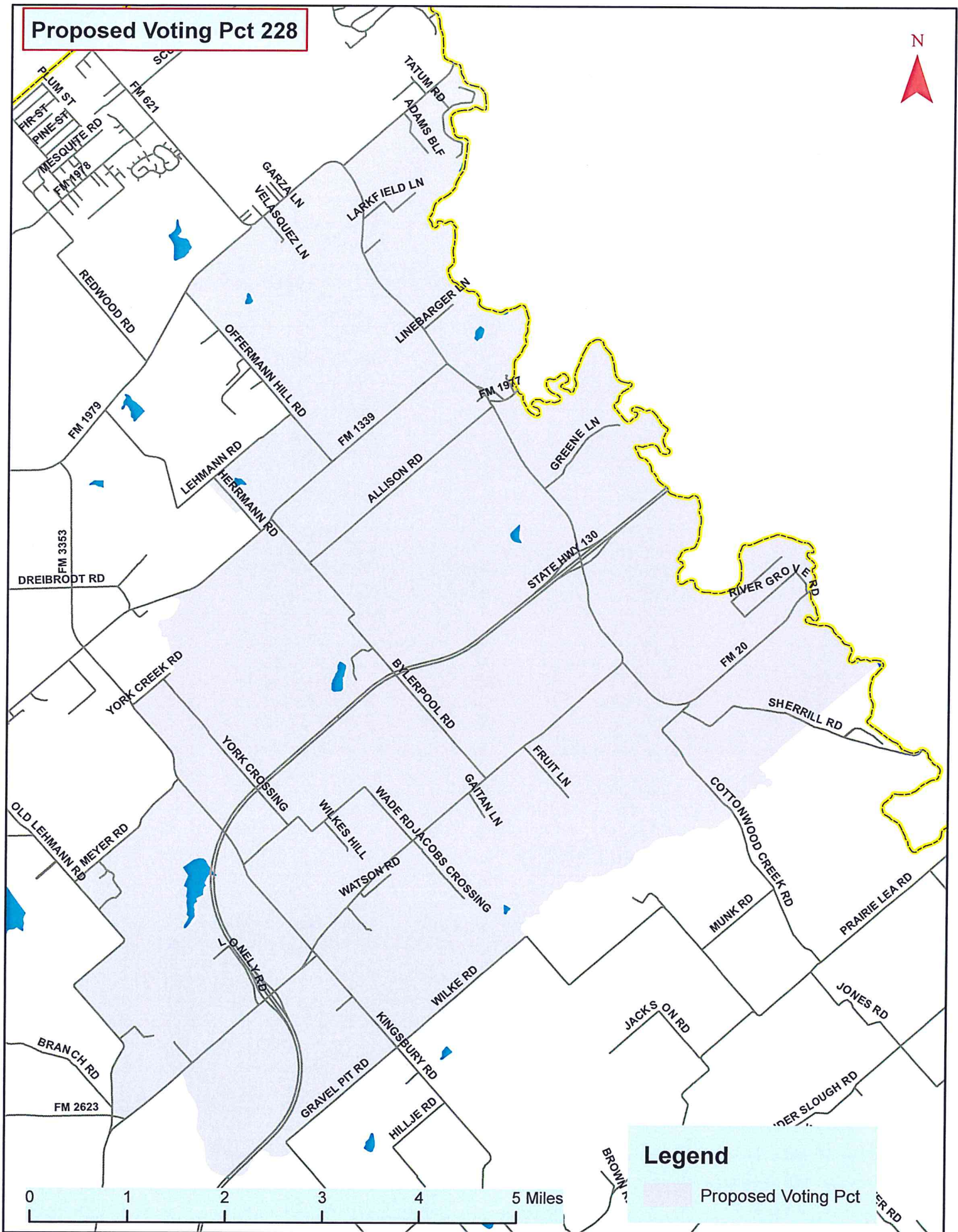



# Proposed Voting Pct 229

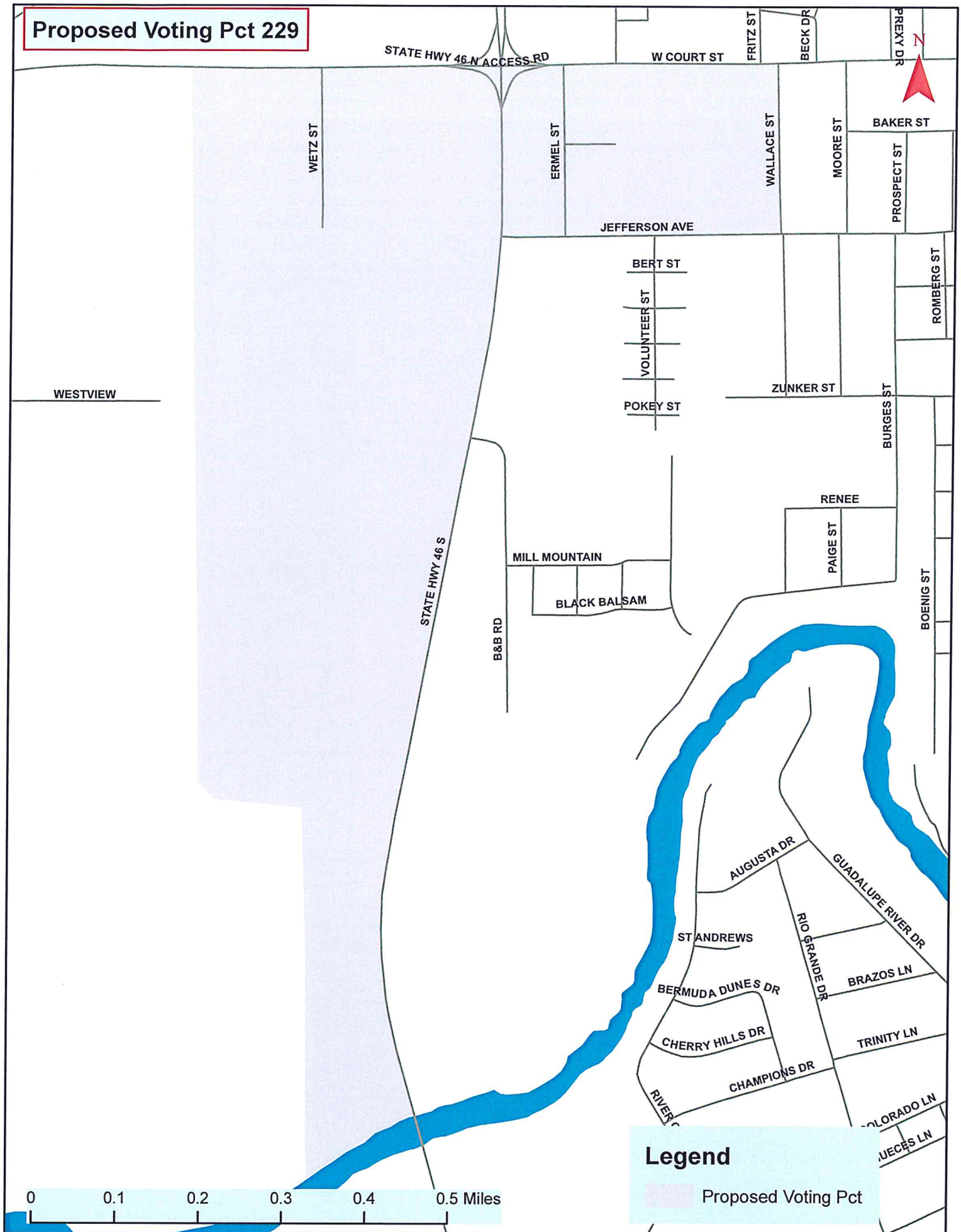

## Legend

Proposed Voting Pct

# Proposed Voting Pct 230

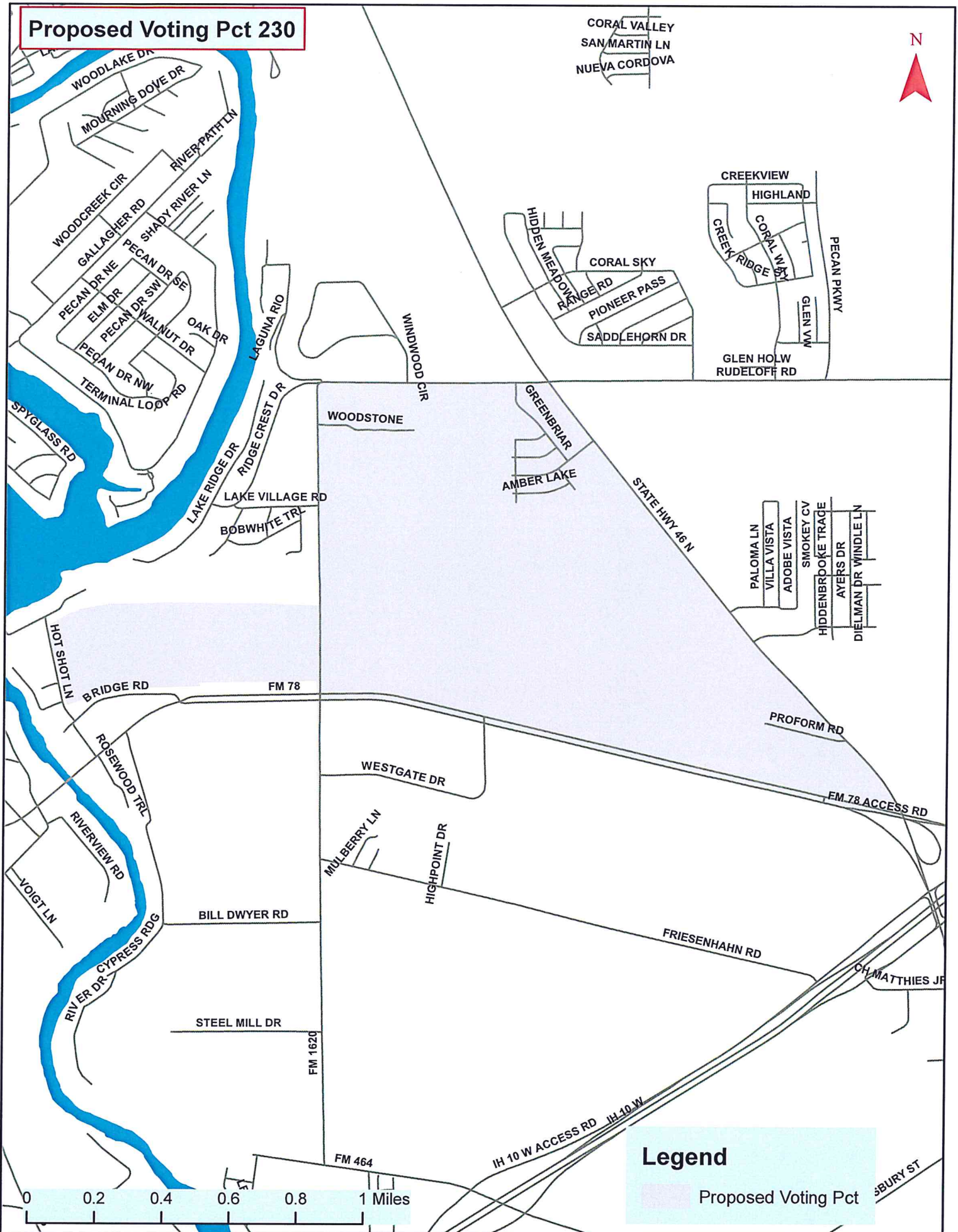



Proposed Voting Pct 231



THREE OAKS RD

STATE HWY 46 N

HORIZON HILL

SILVER RDG

HIDDEN MEADOW

SADDLEHORN DR

CORAL SKY

LAGUNA VISTA DR

LAGUNA RIO

WINDWOOD CIR

RUDELOFF RD

RIDGE DR

RIDGE CREST DR

Legend

Proposed Voting Pct

0 0.1 0.2 0.3 0.4 0.5 Miles

# Proposed Voting Pct 232



CYPRESS SHADOW LN

WINDWOOD CIR

LAGUNA RIO

LAGUNA VISTA DR

## Legend

Proposed Voting Pct

0 0.05 0.1 0.15 0.2 0.25 Miles

RUDELOFF RD



# Proposed Voting Pct 129

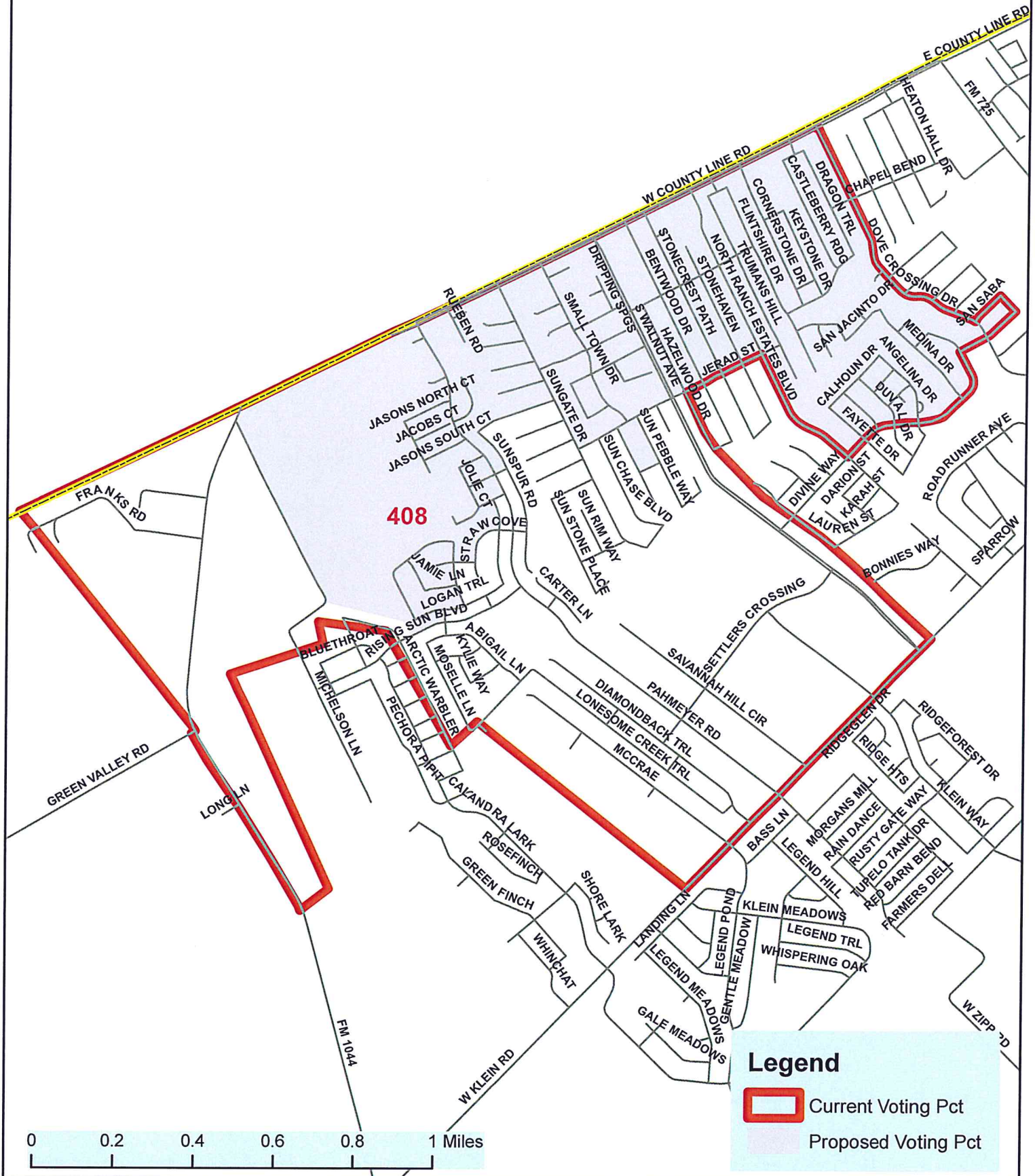



# Proposed Voting Pct 212

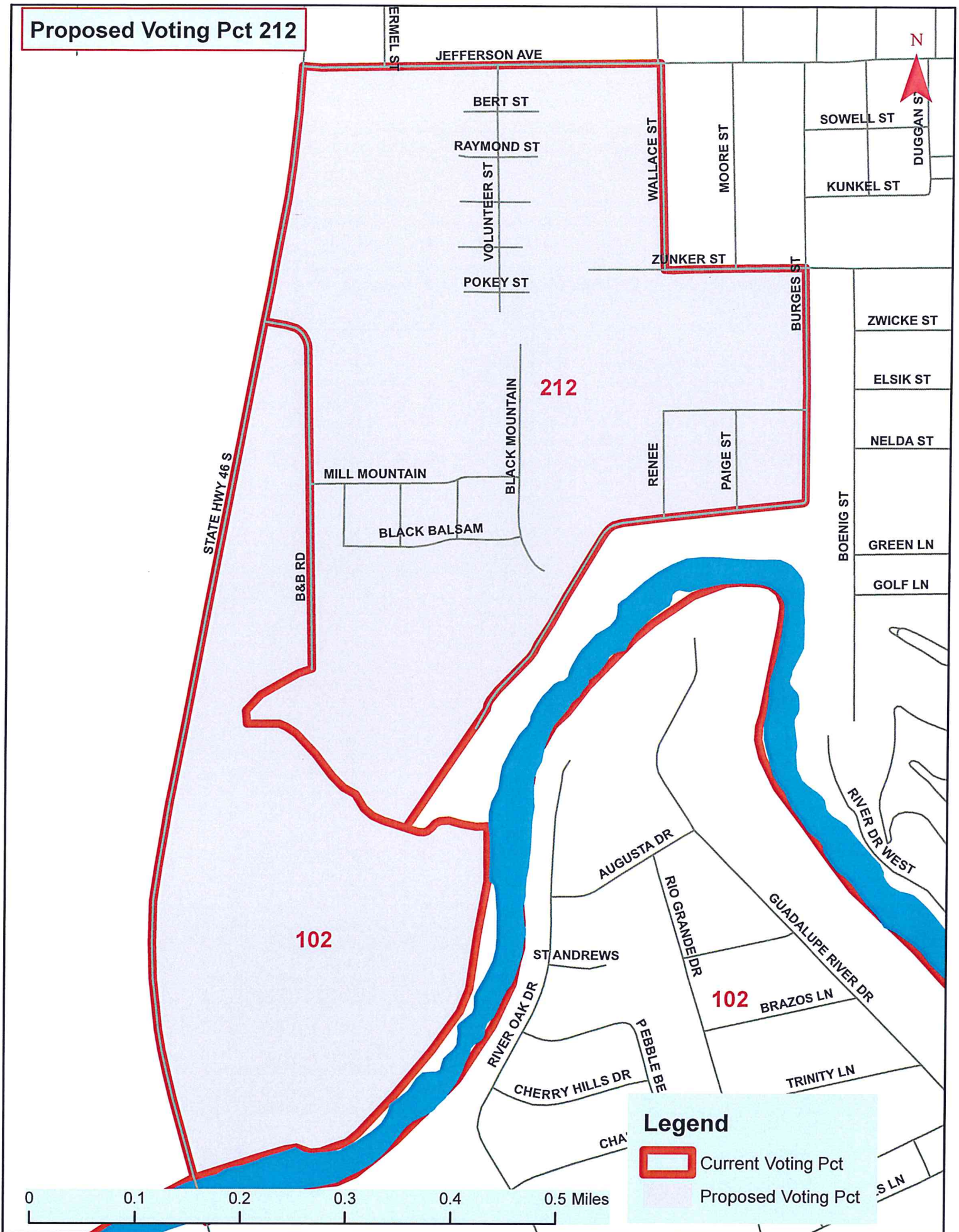



## Proposed Voting Pct 227

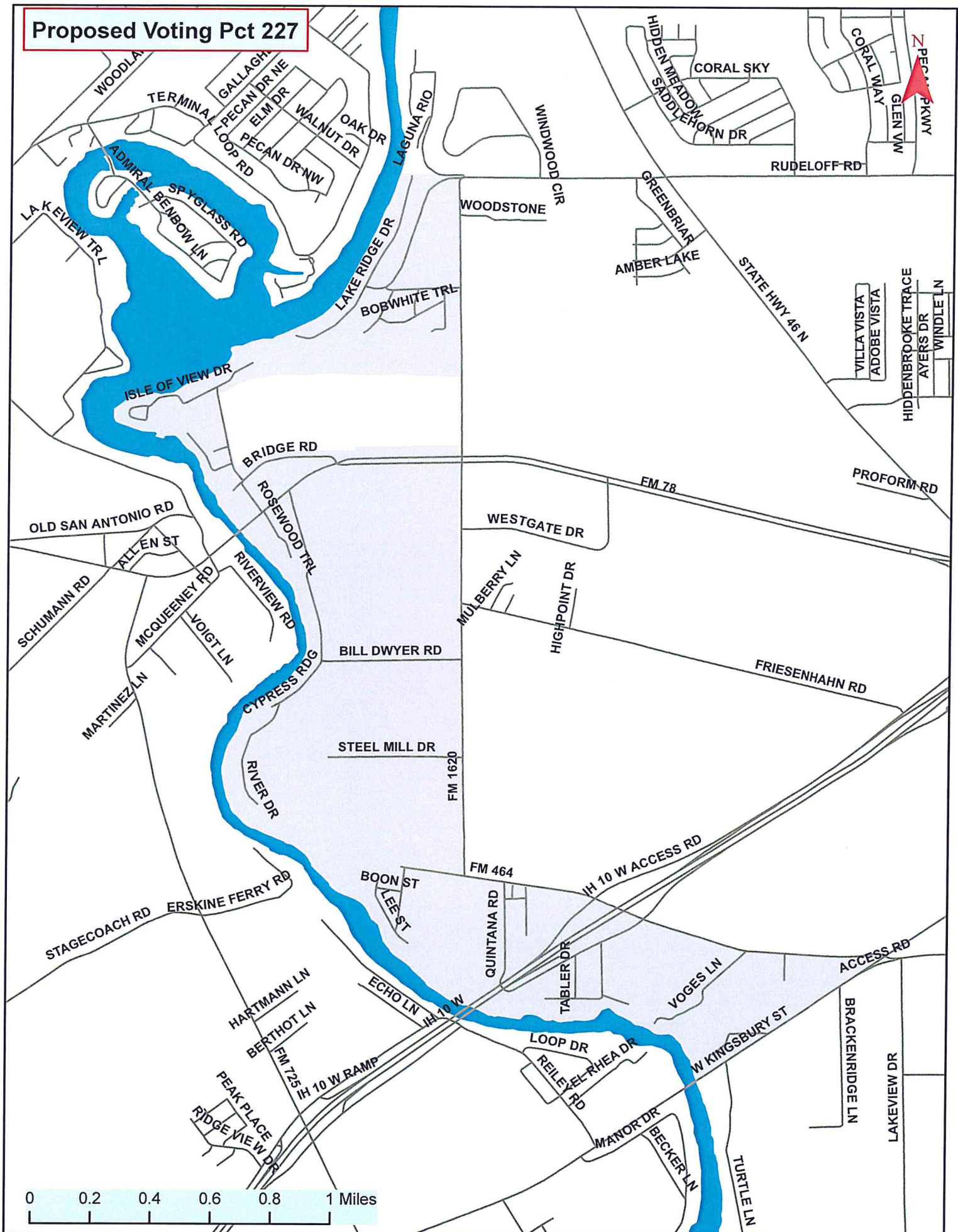



# Proposed Voting Pct 228

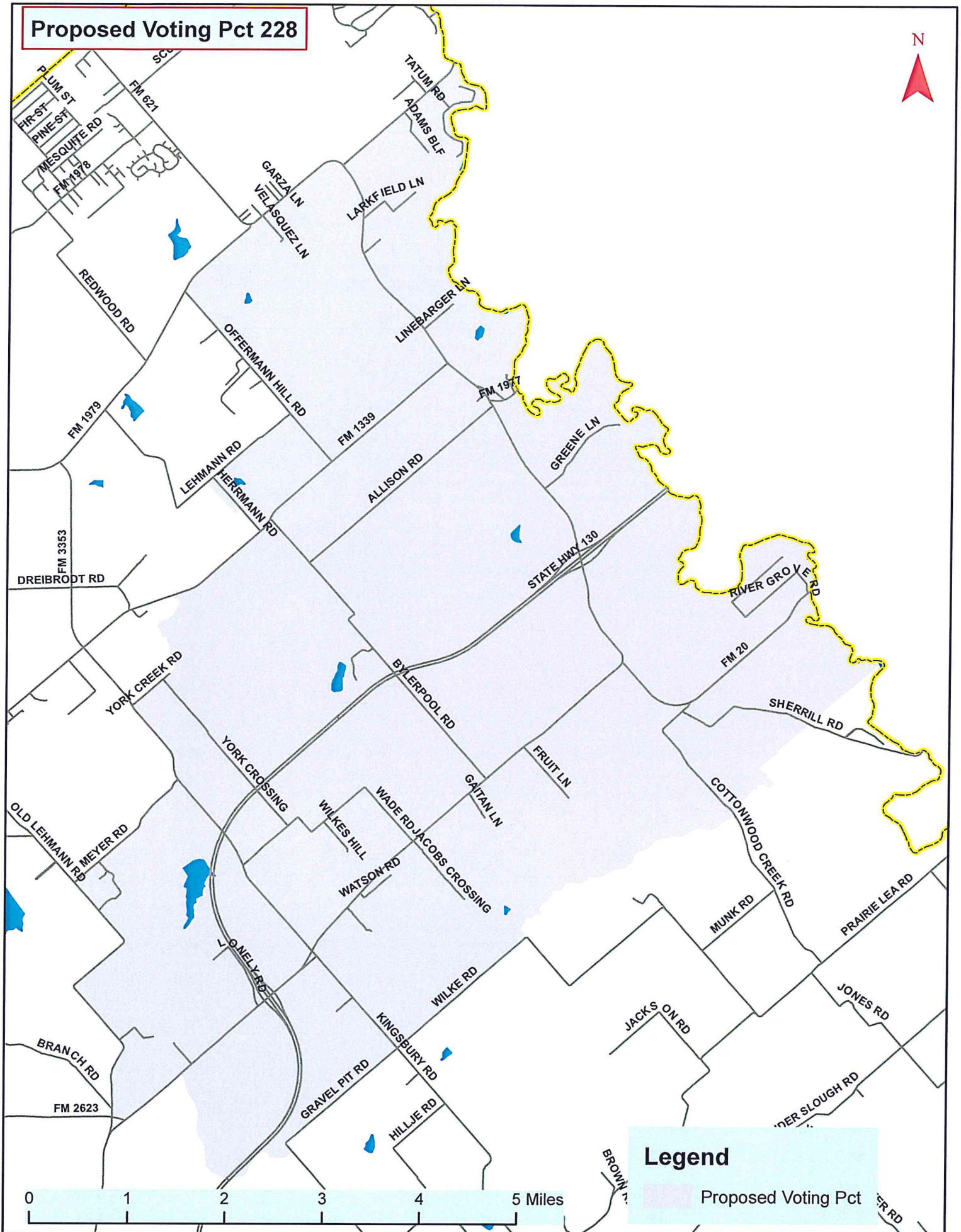

## Legend

Proposed Voting Pct



# Proposed Voting Pct 229

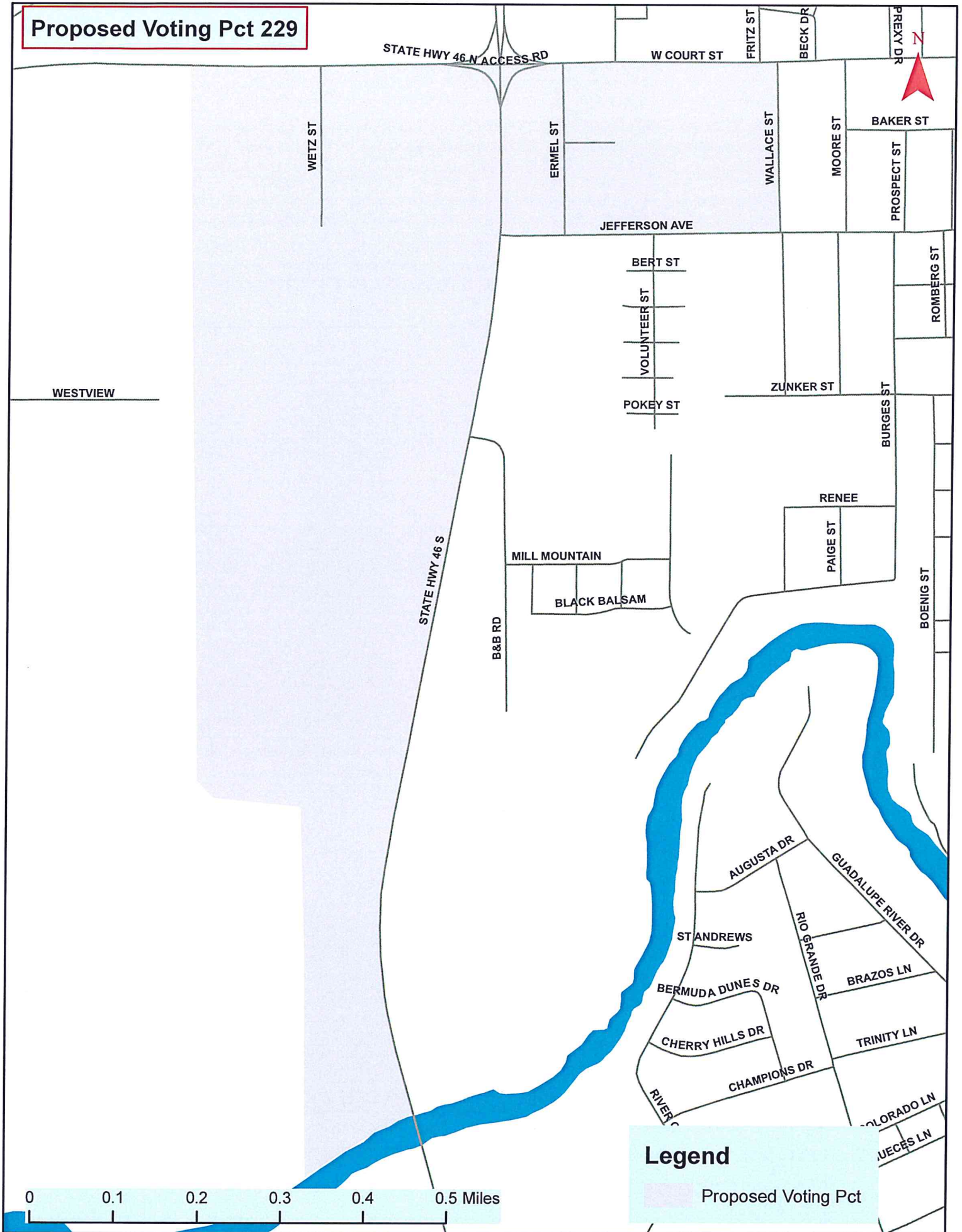

# Proposed Voting Pct 230

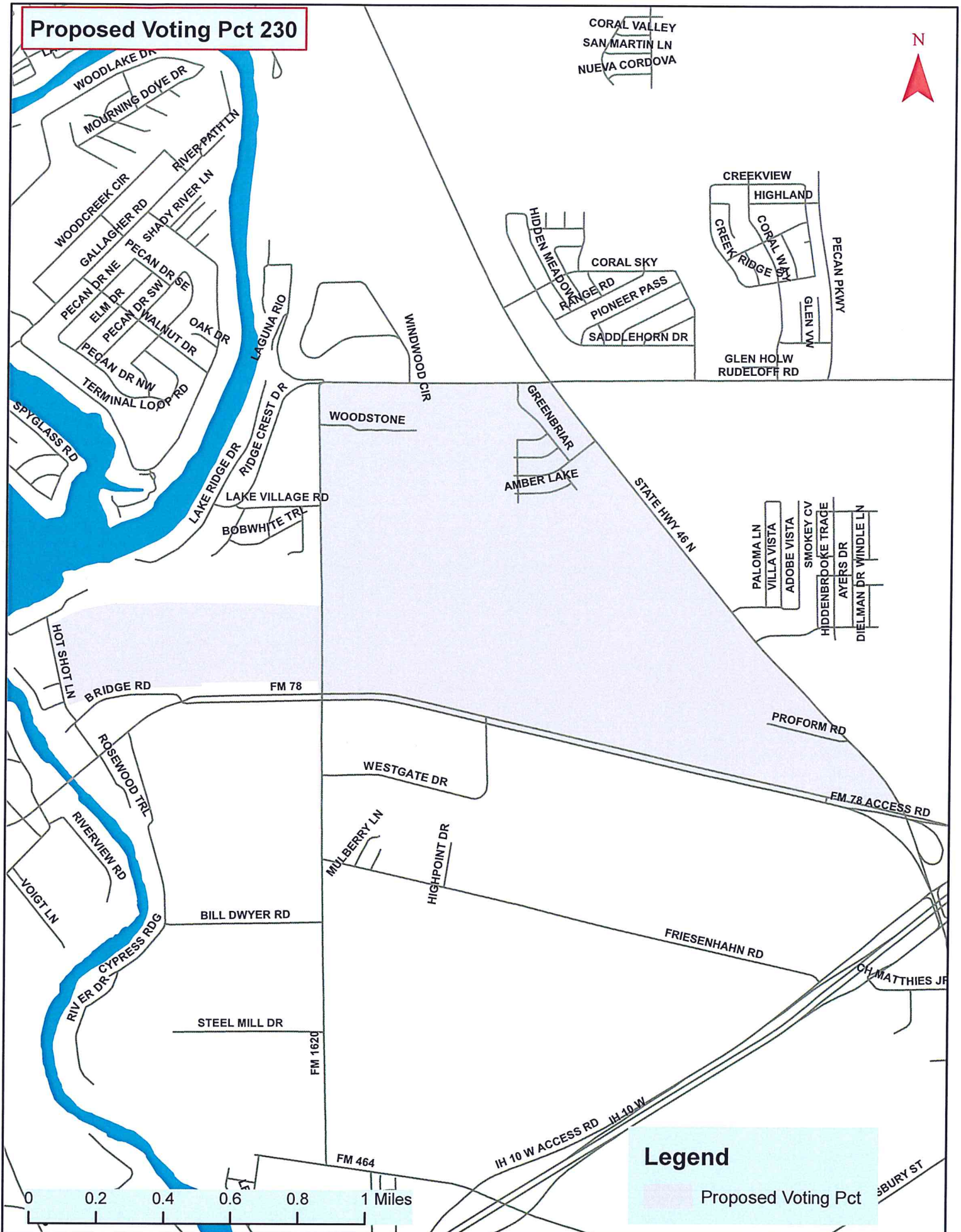



Proposed Voting Pct 231



THREE OAKS RD

STATE HWY 46 N

HORIZON HILL

SILVER RDG

HIDDEN MEADOW

SADDLEHORN DR

CORAL SKY

LAGUNA VISTA DR

LAGUNA RIO

WINDWOOD CIR

RUDELOFF RD

RIDGE DR

RIDGE CREST DR

Legend

Proposed Voting Pct

0 0.1 0.2 0.3 0.4 0.5 Miles

# Proposed Voting Pct 232



CYPRESS SHADOW LN

WINDWOOD CIR

LAGUNA RIO

LAGUNA VISTA DR

## Legend

Proposed Voting Pct

0 0.05 0.1 0.15 0.2 0.25 Miles

RUDELOFF RD



# Proposed Voting Pct 309

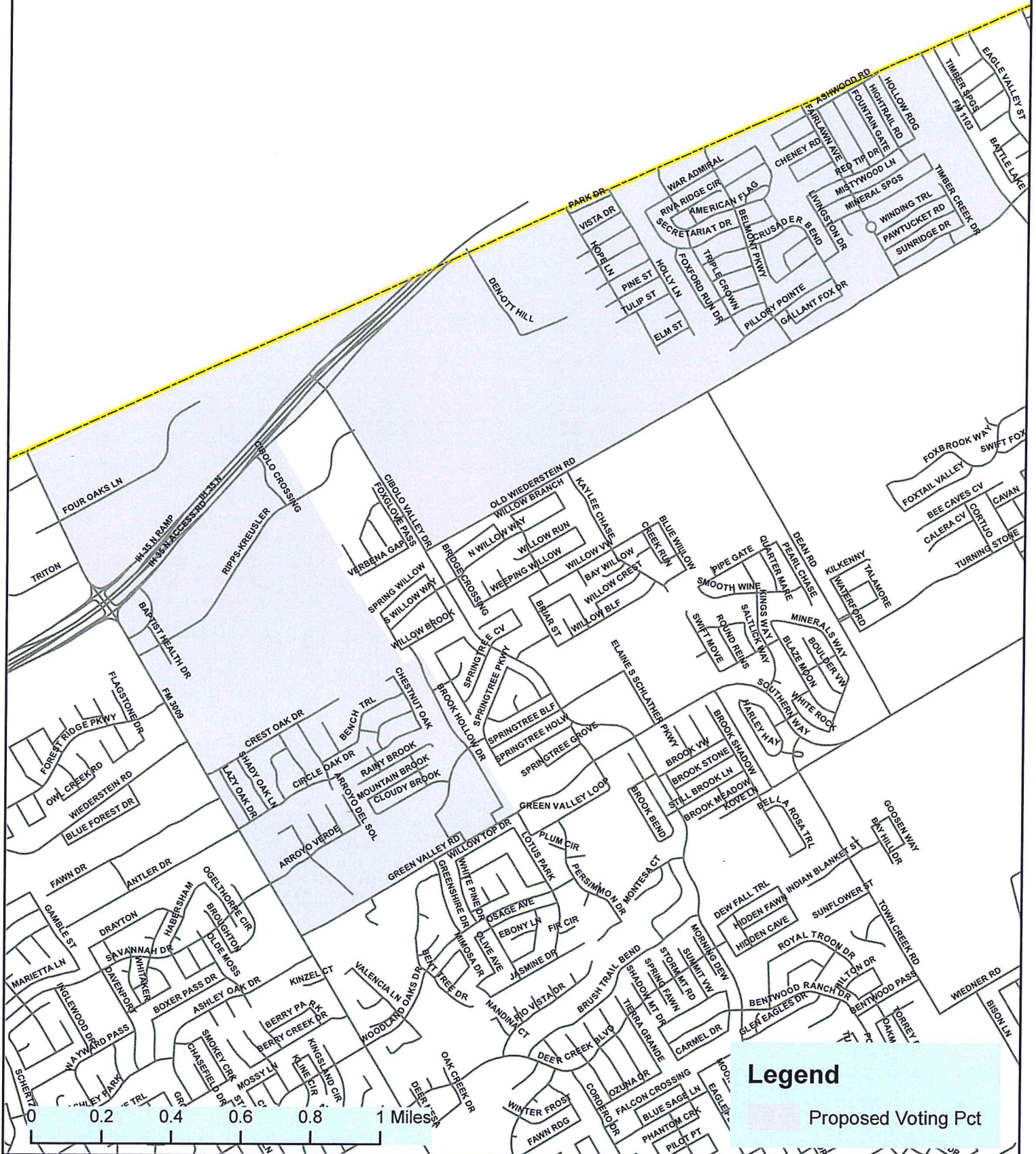



## Proposed Voting Pct 414

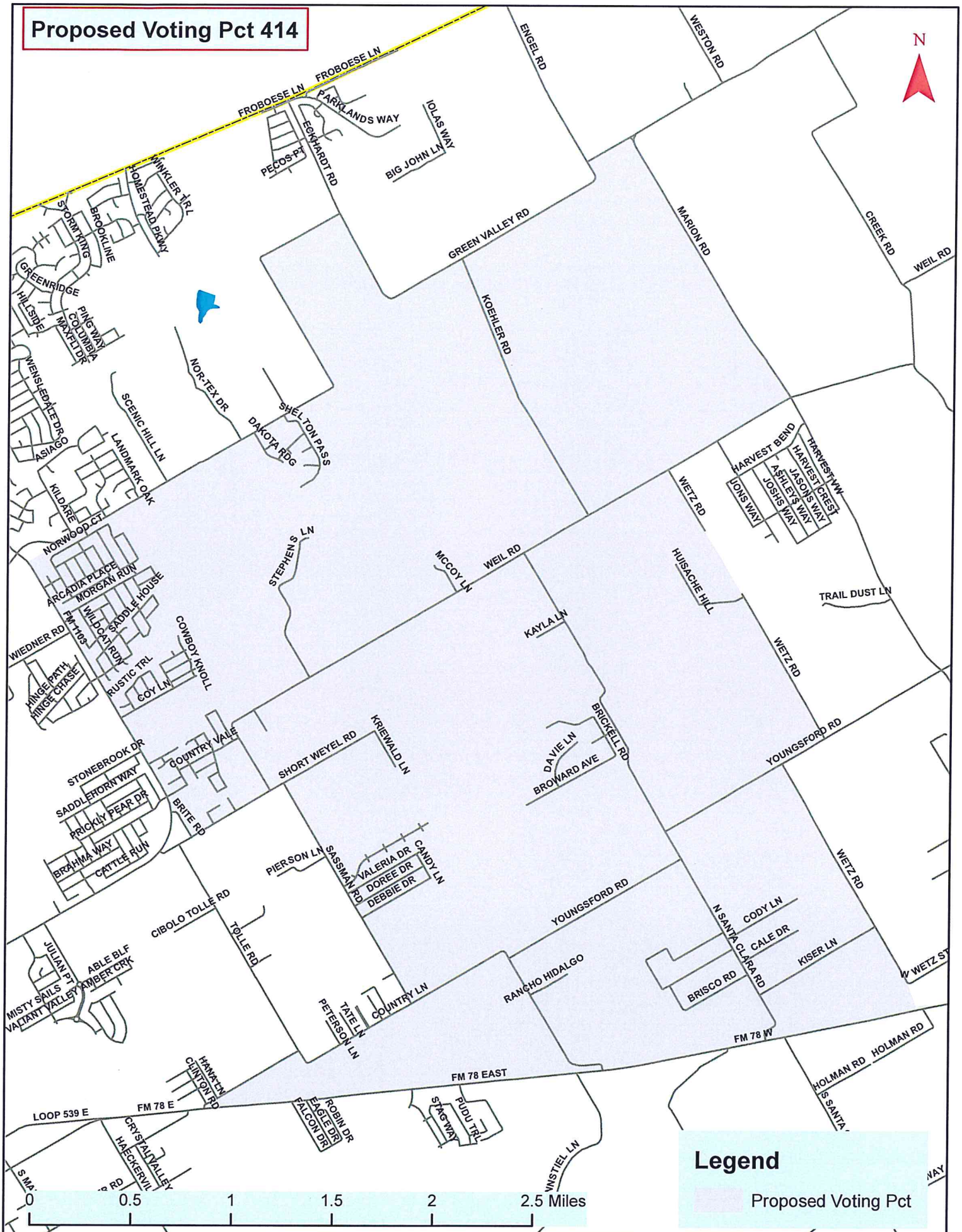



# Proposed Voting Pct 415

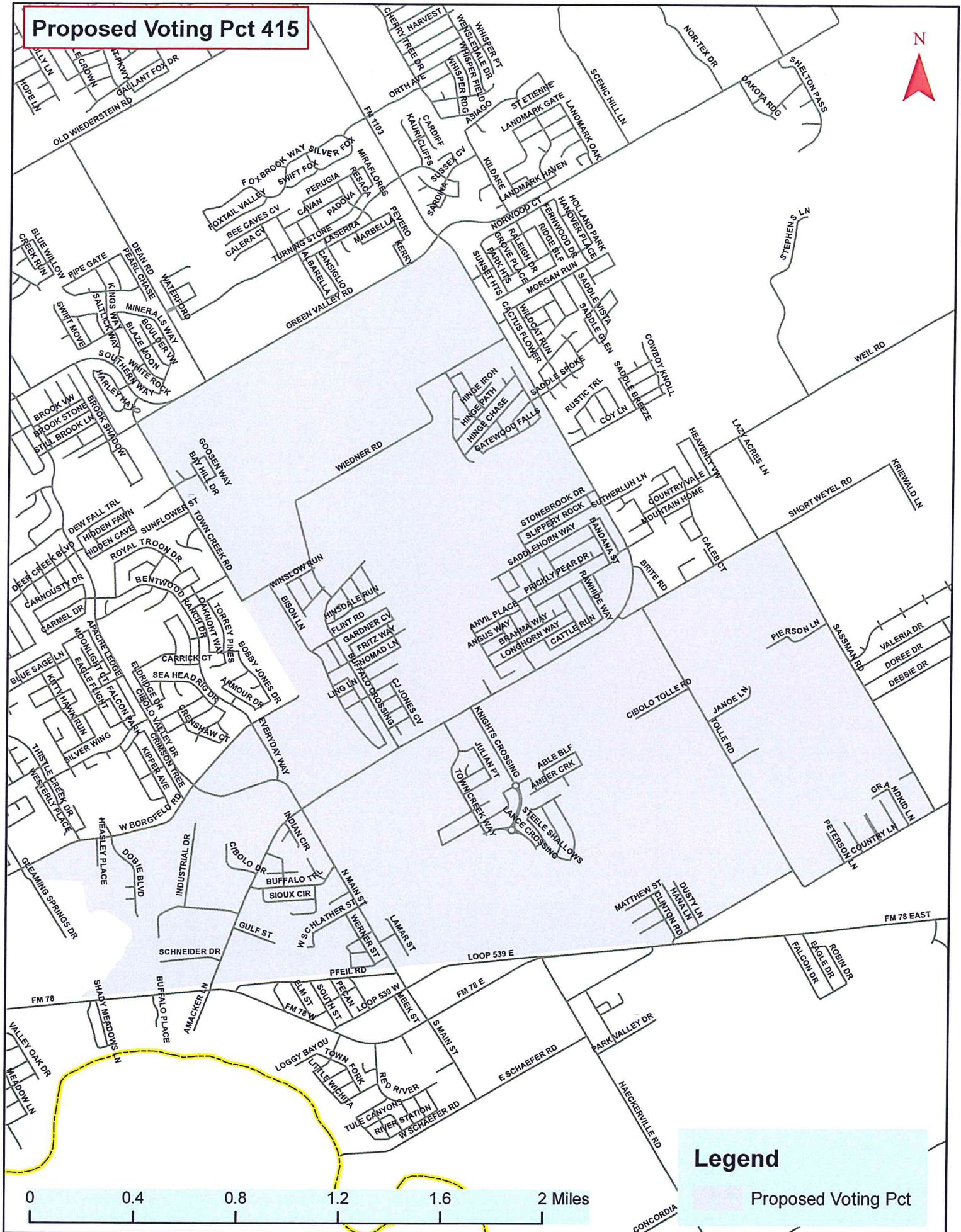



## Proposed Voting Pct 129

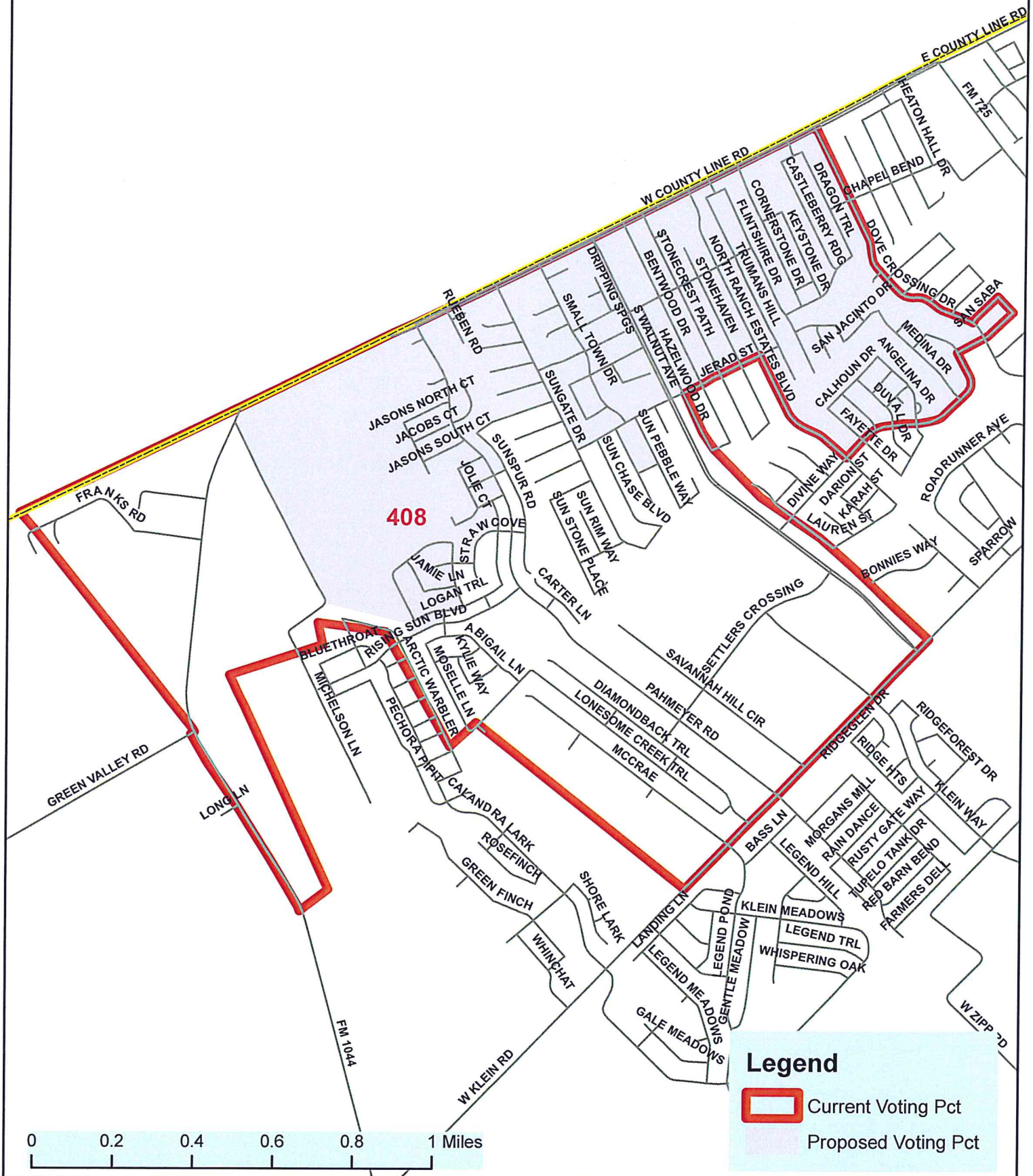



# Proposed Voting Pct 309

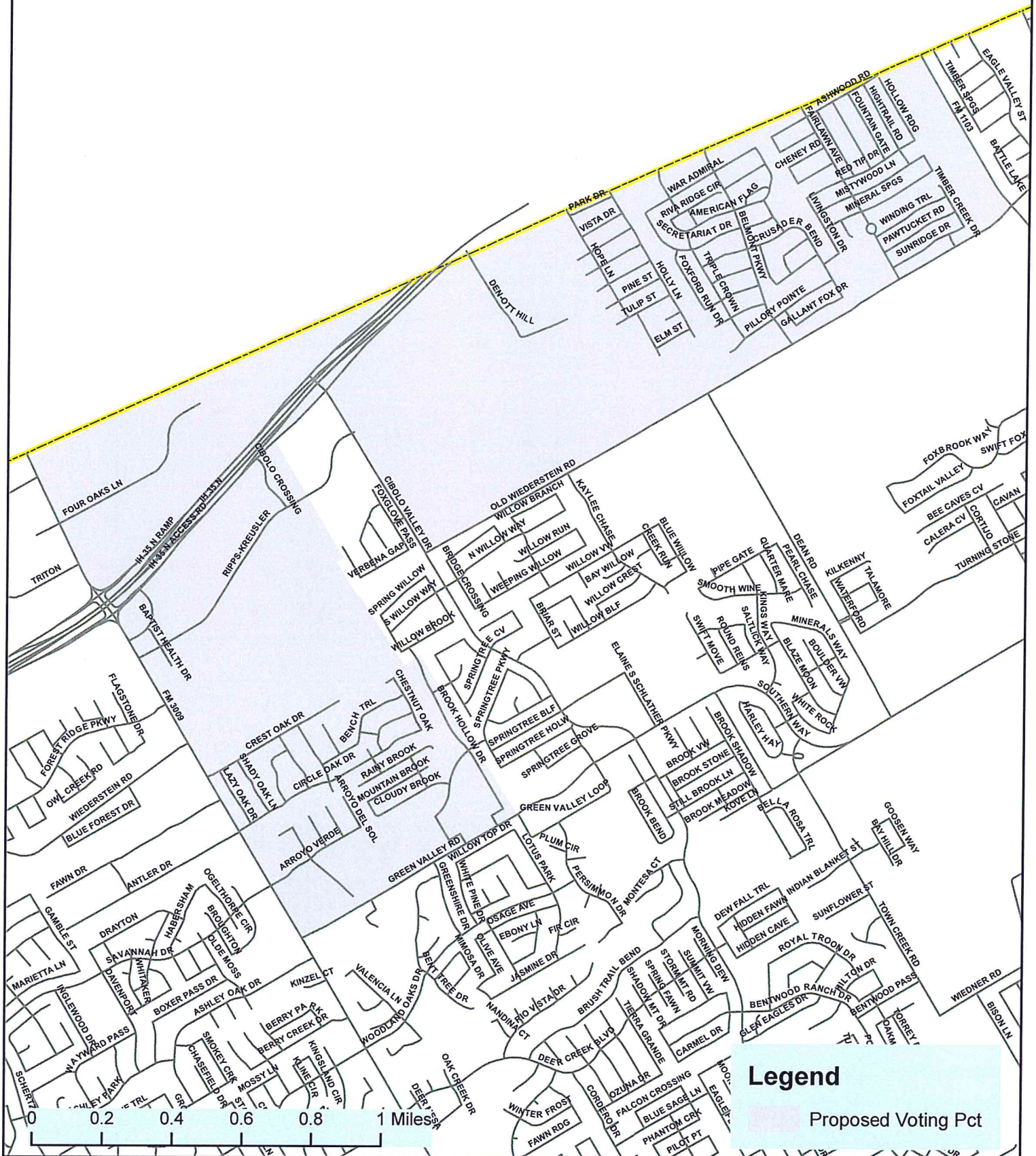



# Proposed Voting Pct 310

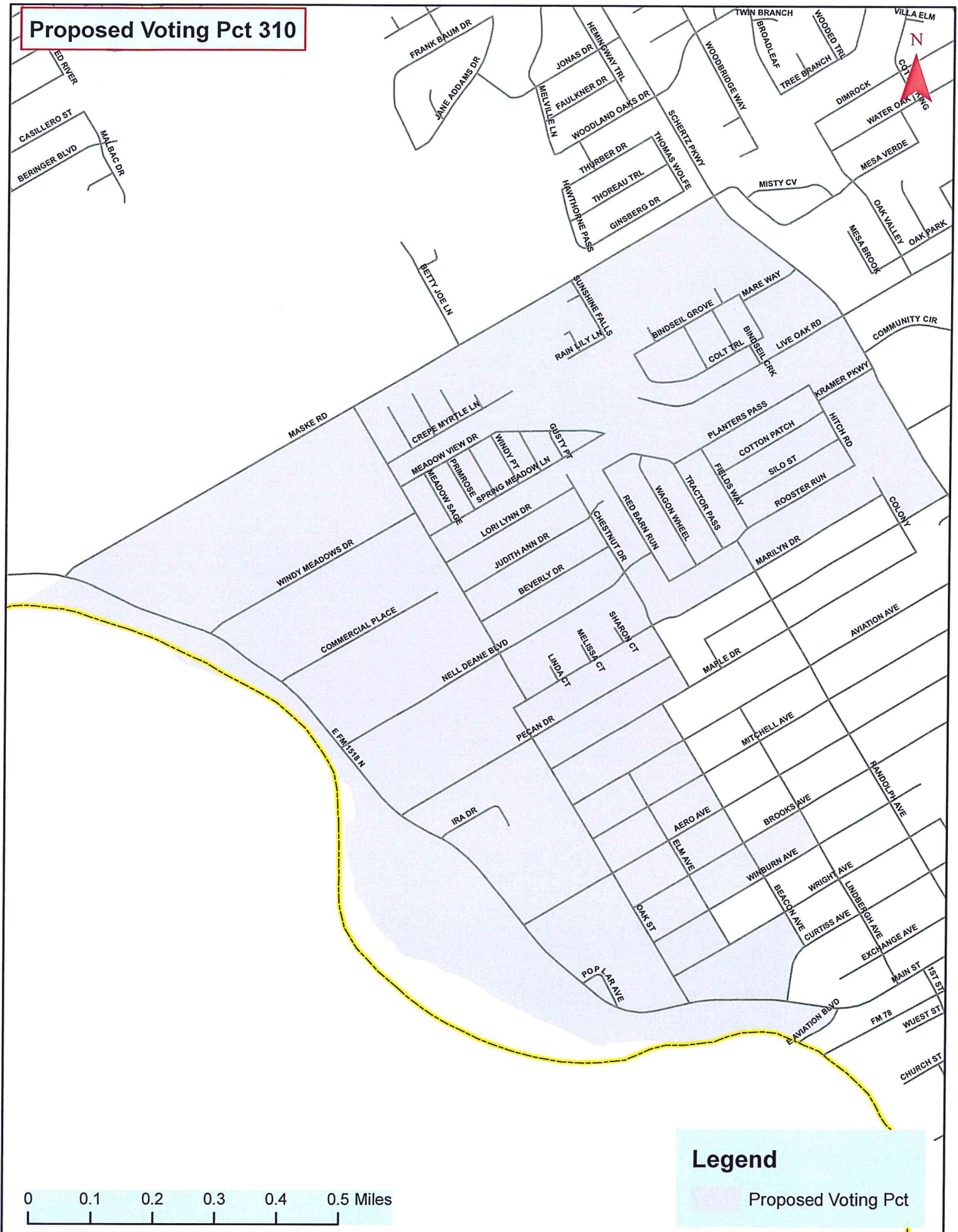



## Proposed Voting Pct 311

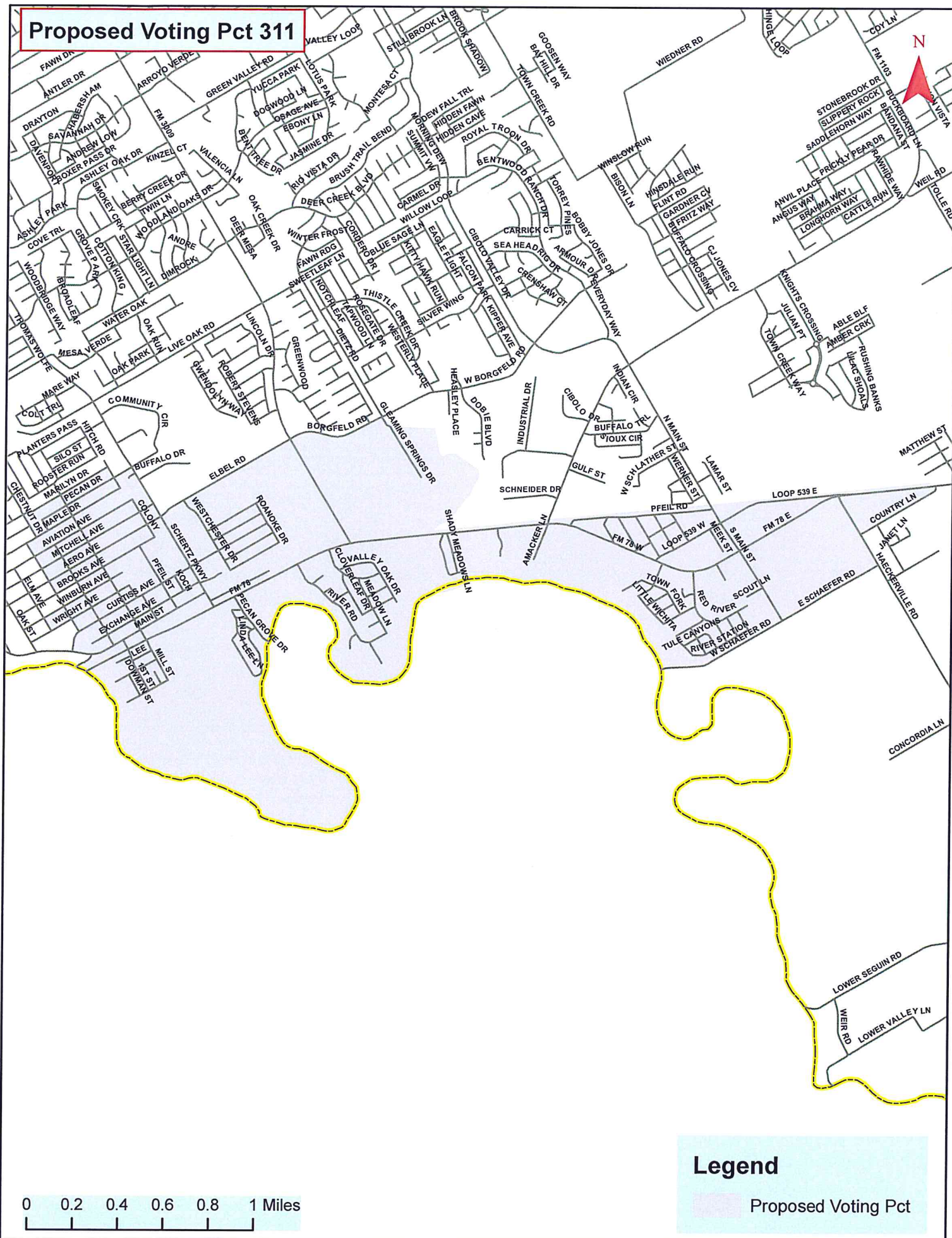



## Proposed Voting Pct 401

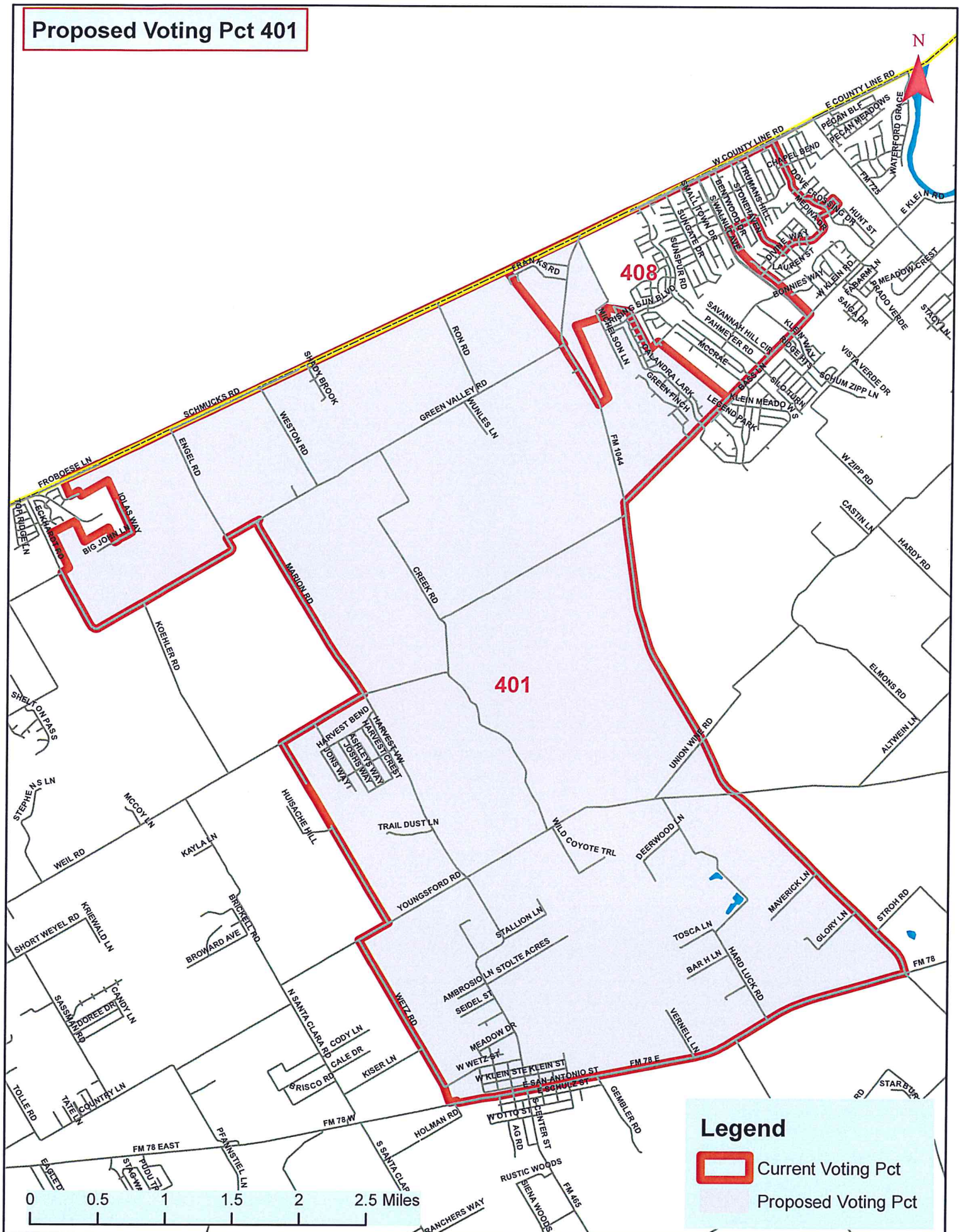



# Proposed Voting Pct 406

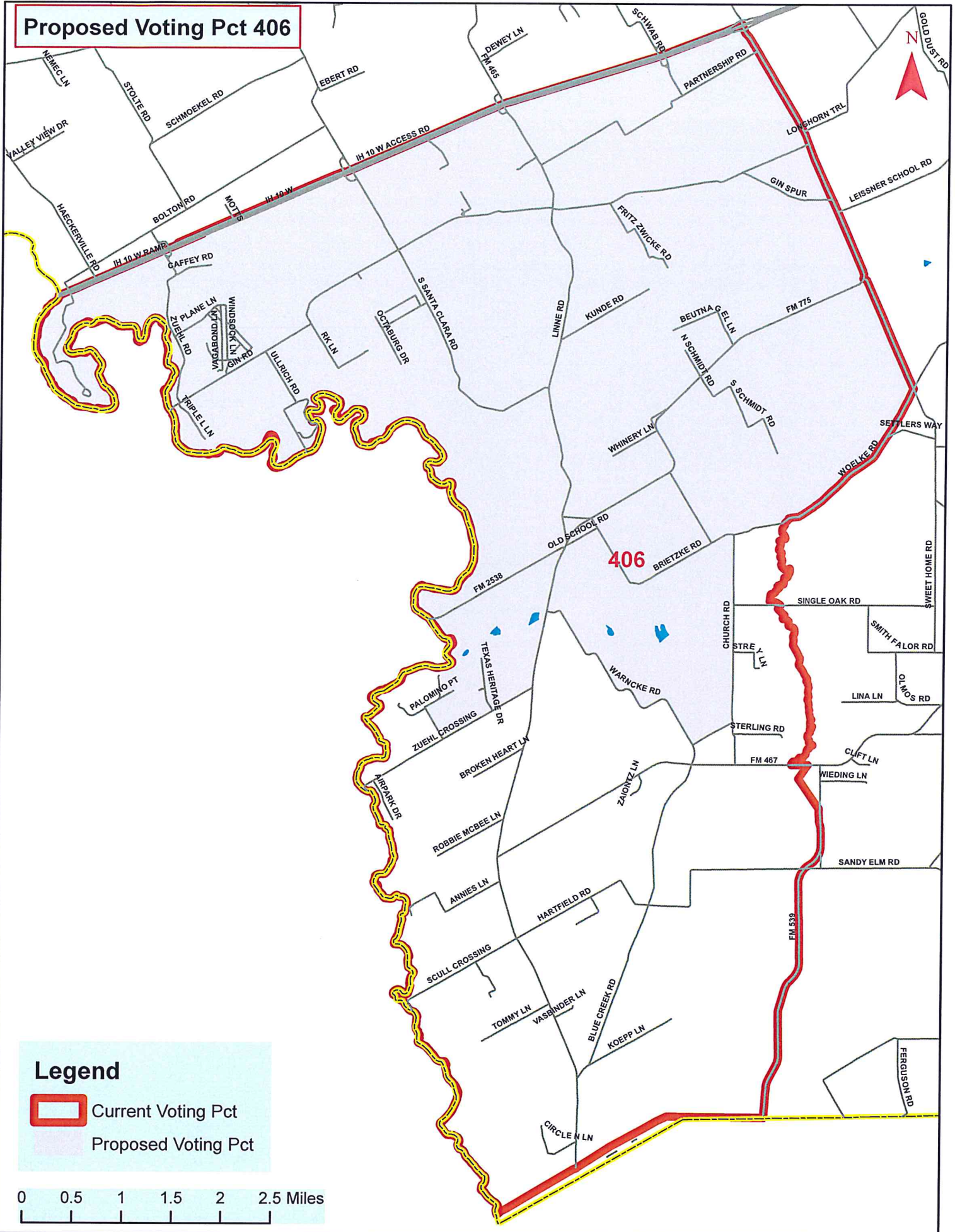

# Proposed Voting Pct 413

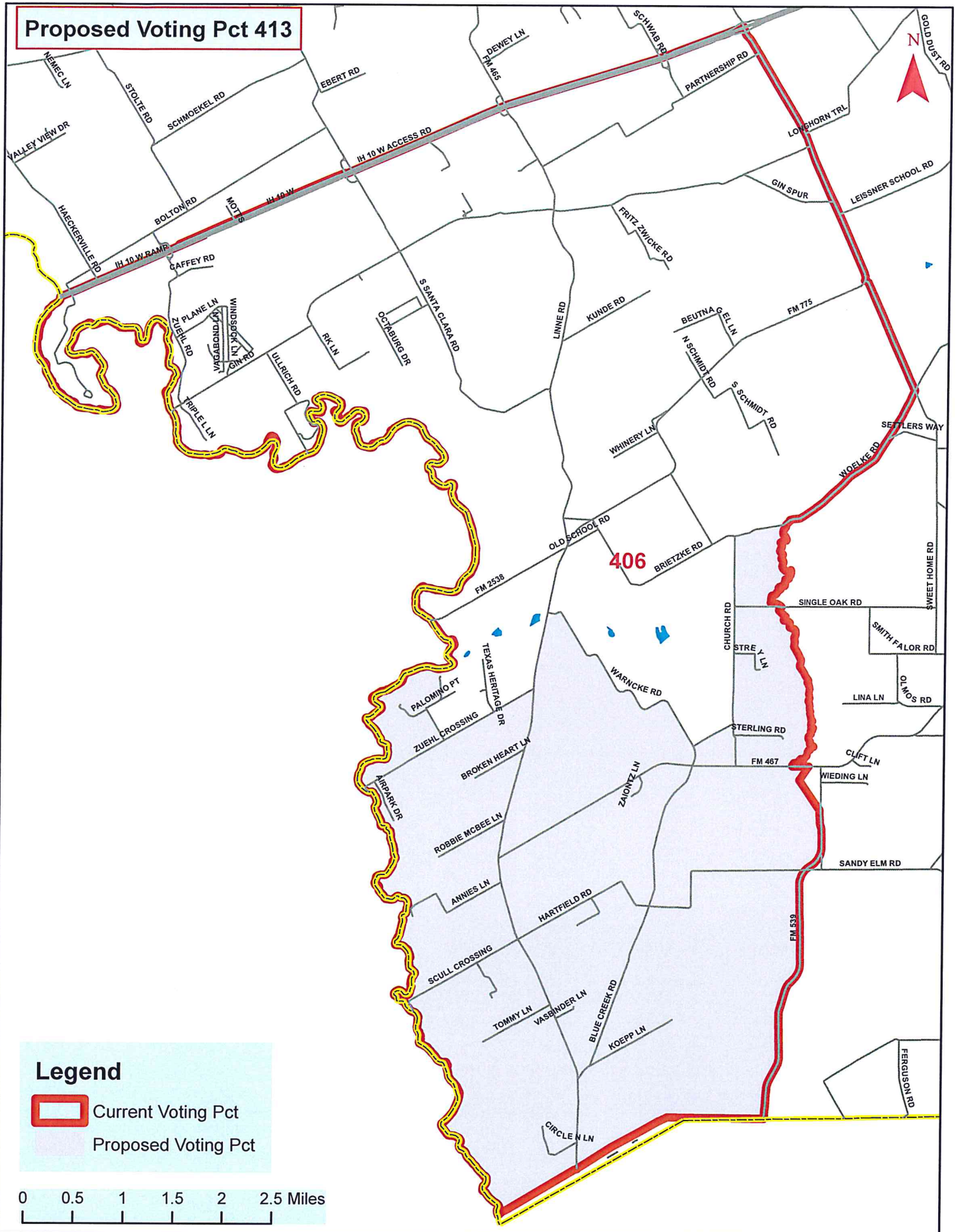



# Proposed Voting Pct 414

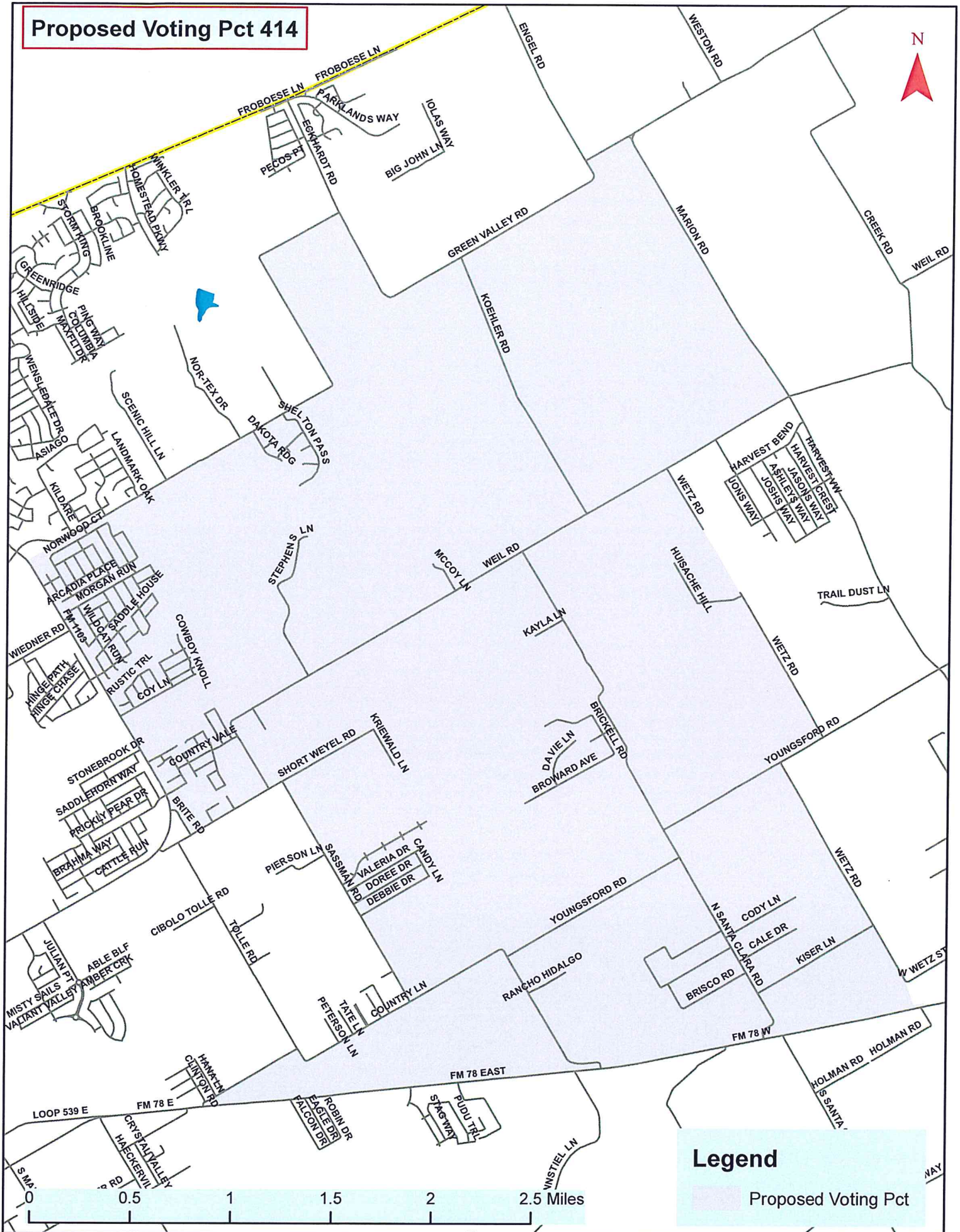

## Legend

Proposed Voting Pct



# Proposed Voting Pct 415

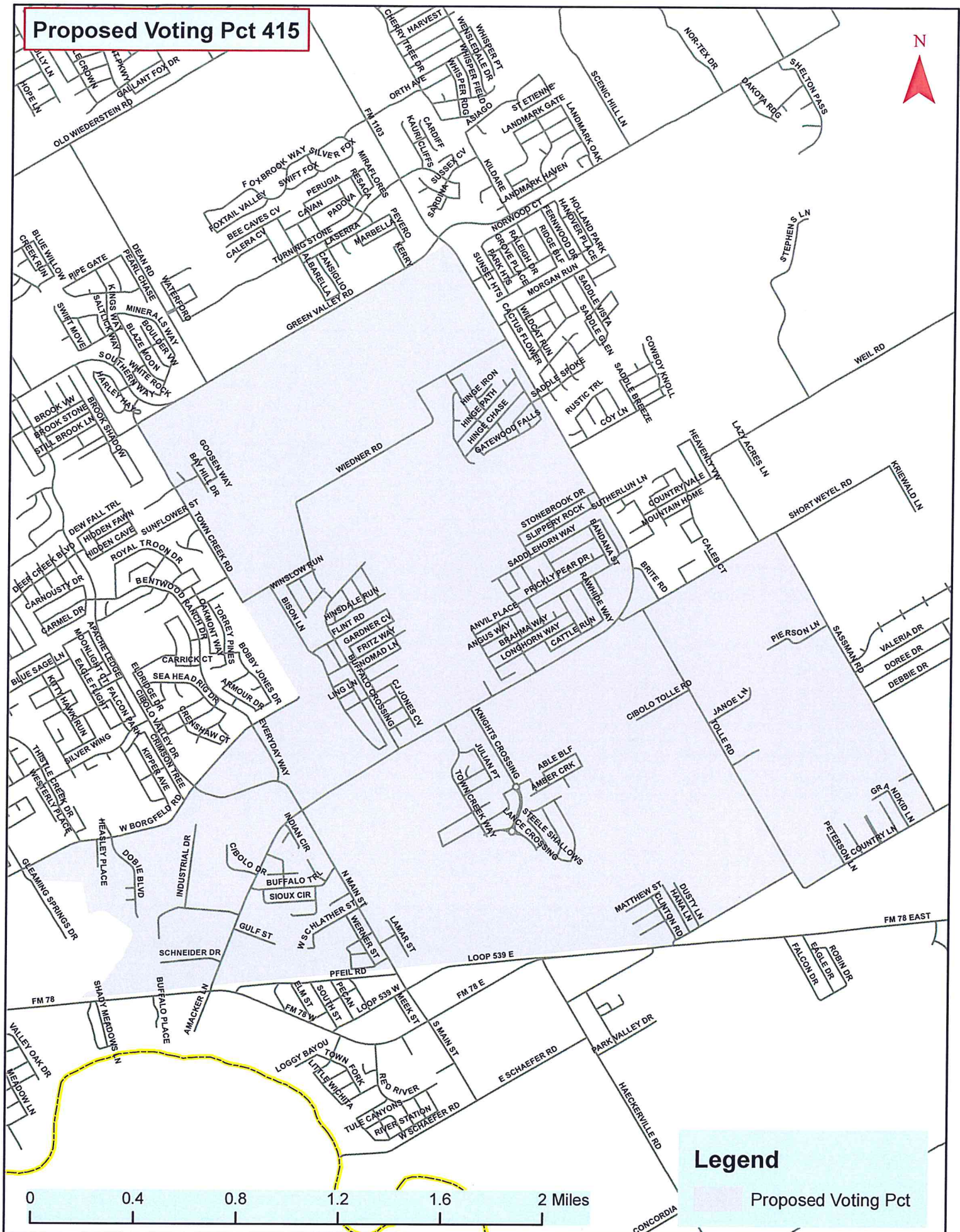



### Commissioner, Precinct 1 changes:

Voting Pct 101 was moved into Comm Pct 2 and renamed Voting Pct 227  
Voting Pct 102\_a portion, north of the river, was moved into Comm Pct 2 and became part of Voting Pct 212  
Voting Pct 108 was moved into Comm Pct 2 and renamed Voting Pct 228  
Voting Pct 111 was moved into Comm Pct 2 and renamed Voting Pct 229  
Voting Pct 118 was moved into Comm Pct 2 and renamed Voting Pct 230  
Voting Pct 121 was moved into Comm Pct 2 and renamed Voting Pct 231  
Voting Pct 122 was moved into Comm Pct 2 and renamed Voting Pct 232

Voting Pct 129 was created from a portion of Voting Pct 408 that was split by Comm Pcts 1 and 4, with the dividing line being a portion of Dove Crossing Dr, San Saba, Fannin Dr, Eagle Pass Dr, Divine Way, North Ranch Estates Blvd, Jerad St, Sun Pebble Way, Ridge Gate, Garden Sun Place, Sun Gate Dr, Sunspur Dr, Sunspur Rd, Lower Forty, Pahmeyer Rd, Strawberry Field, Broken Wheel Ln, Straw Cove, Twisted River, Jeffrey Ln, Logan Trl, Elbe Way, Rising Sun Blvd, Arctic Warbler, undeveloped area, Michelson Ln & FM 1044.

### Commissioner, Precinct 2 changes:

Comm Pct 2 gained Voting Pcts 227, 228, 229, 230, 231, 232 from Voting Pcts 101, 108, 111, 118, 121, and 122  
Comm Pct 2 gained a portion of Voting Pct 102, north of the river, it was combined with Voting Pct 212

### Commissioner, Precinct 3 changes:

Voting Pct 301 was moved into Comm Pct 4 and renamed Voting Pct 414  
Voting Pct 302 was moved into Comm Pct 4 and renamed Voting Pct 415  
Voting Pct 411 was moved into Comm Pct 3 and renamed Voting Pct 309

### Commissioner, Precinct 4 changes:

Voting Pct 402 was moved into Comm Pct 3 and renamed Voting Pct 310  
Voting Pct 403 was moved into Comm Pct 3 and renamed Voting Pct 311

Voting Pct 406 was split by US Rep 28 and US Rep 15, creating new Voting Pct 413, with the dividing line being along a portion of: Woelke Rd, Church Rd, Warncke Rd, FM 775, Zuehl Crossing, Cibolo Pt, Palomino Pt & Wild Dog Ln. The north portion is Voting Pct 406 and the south portion is Voting Pct 413

Voting Pct 408 was split by Comm Pct 4 and Comm Pct 1. A portion of Voting Pct 408 became Voting Pct 129, in Comm Pct 1. A portion of Voting Pct 408 was moved into Voting Pct 401, to be more contiguous. The area moved in to Voting Pct 401 was the area on the west side, bordered by Michaelson Ln, an undeveloped area and FM 1044, and another undeveloped area.

Voting Pct 301 was moved into Comm Pct 4 and renamed Voting Pct 414  
Voting Pct 302 was moved into Comm Pct 4 and renamed Voting Pct 415  
Voting Pct 411 was moved into Comm Pct 3 and renamed Voting Pct 309